

Kinnear Centre—Ground Floor

Room Name and/or Number	Classroom (2/table)	Classroom (3/table)	Theatre	Rounds of 6	Rounds of 8	Rounds of 10	U-Shape	Reception	Dimensions (metres) L x W	Dimensions (feet) L x W	Area (metres ²)	Area (feet ²)	Ceiling Height (metres)	Ceiling Height (feet)
Cenovus Great Hall Room 101	48	72	126	54	72	90	39	175	12.5 x 12.5	41 x 41	156.25	1,681	3.95	13'
Cenovus Great Hall Room 103	80	114	196	102	136	170	51	266	12.5 x 19	41 x 62.4	237.5	2,558	3.95	13'
Cenovus Great Hall Room 105	48	72	126	54	72	90	39	175	12.5 x 12.5	41 x 41	156.25	1,681	3.95	13'
Cenovus Great Hall Rooms 101 & 103 Combined	130	195	308	138	184	230	162	442	12.5 x 31.5	41 x 103.4	393.75	4,239	3.95	13'
Cenovus Great Hall Rooms 103 & 105 Combined	130	195	308	138	184	230	162	442	12.5 x 31.5	41 x 103.4	393.75	4,239	3.95	13'
Cenovus Great Hall 101, 103 & 105 Combined	180	270	428	210	280	350		617	12.5 x 44	41 x 144.4	550	5,920	3.95	13'

Please Note: All capacity numbers are based on basic AV set-ups.
All room set-ups based on using banquet chairs, except where indicated.

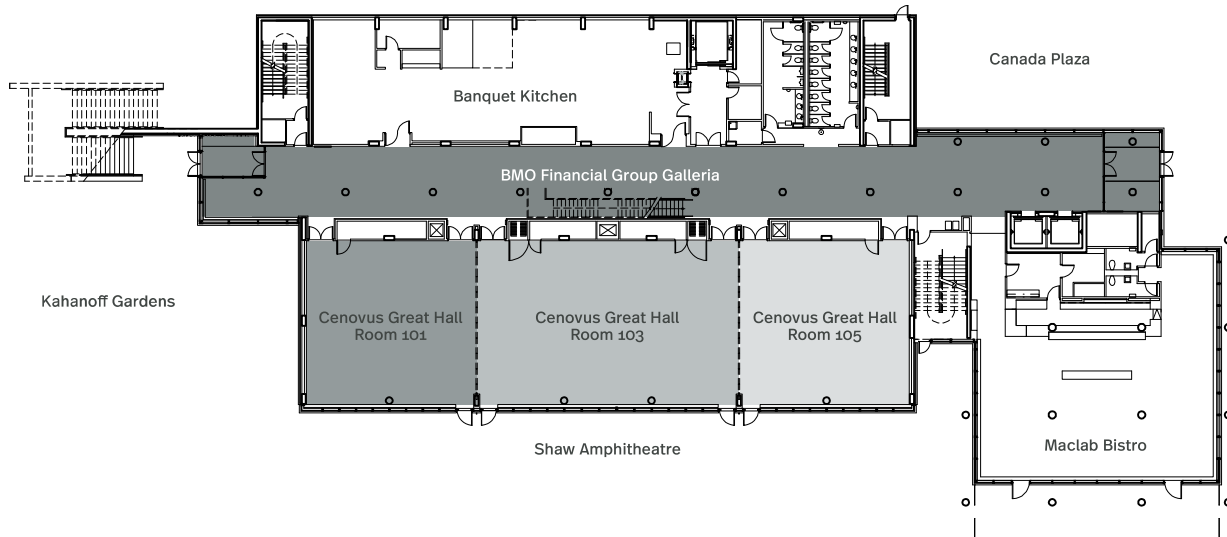

Kinnear Centre–Second Floor

Room Name and/or Number	Classroom (2/ table)	Classroom (3/ table)	Theatre	Rounds of 6	Rounds of 8	Rounds of 10	U-Shape	Reception	Dimensions (metres) L x W	Dimensions (feet) L x W	Area (metres ²)	Area (feet ²)	Ceiling Height (metres)	Ceiling Height (feet)
Room 201	48	72	126	54	72	90	39	175	12.5 x 12.5	41 x 41	156.25	1,681	3.3	10'10"
Room 203	80	114	196	102	136	170	51	266	12.5 x 19	41 x 62.4	237.5	2,558	3.3	10'10"
Room 205	48	72	126	54	72	90	39	175	12.5 x 12.5	41 x 41	156.25	1,681	3.3	10'10"
Rooms 201 & 203 Combined	130	195	308	138	184	230		442	12.5 x 31.5	41 x 103.4	393.75	4,239	3.3	10'10"
Rooms 203 & 205 Combined	130	195	308	138	184	230		442	12.5 x 31.5	41 x 103.4	393.75	4,239	3.3	10'10"
Rooms 201, 203 & 205 Combined	152	228	420	198	264	330		617	12.5 x 44	41 x 144.4	550	5,920	3.3	10'10"
Gibson Energy Room 202	16	24	32	12	16	20	21		7.8 x 4.8	25.7 x 15.9	37.44	408	3.35	11'
Encana Corporation Room 204	12	18	32	12	16	20	21		7.2 x 4.8	23.8 x 15.9	34.56	378	3.35	11
Calgary Flames Foundation Room 206	16	24	36	18	24	30	24		8.8 x 5.1	28.11 x 16.9	44.88	475	3.35	11
Cenovus Energy Room 208	12	18	32	12	16	20	21		7.2 x 4.8	23.8 x 15.9	34.56	378	3.35	11
Bird Construction Company Learning Space Room 210	12	18	32	12	16	20	21		7.8 x 4.8	25.7 x 15.9	37.44	408	3.35	11

Please Note: All capacity numbers are based on basic AV set-ups. All room set-ups based on using banquet chairs, except where indicated.

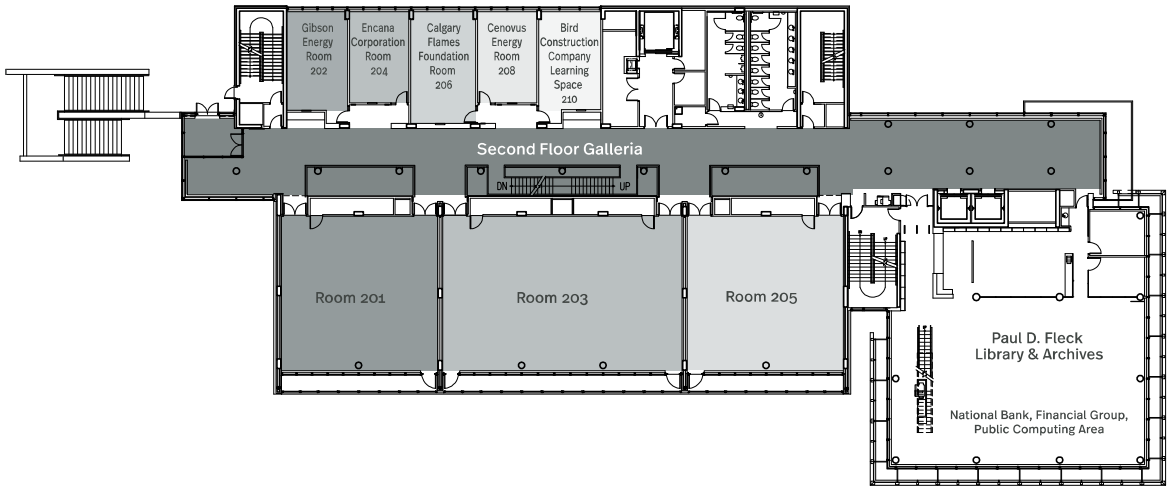

Kinnear Centre—Third Floor

Room Name and/or Number	Classroom (2/table)	Classroom (3/table)	Theatre	Rounds of 6	Rounds of 8	Rounds of 10	U-Shape	Reception	Dimensions (metres) L x W	Dimensions (feet) L x W	Area (metres ²)	Area (feet ²)	Ceiling Height (metres)	Ceiling Height (feet)
Room 301	48	72	126	54	72	90	39	175	12.5 x 12.5	41 x 41	156.25	1,681	3.6	11'10"
Room 303	80	114	196	102	136	170	51	266	12.5 x 19	41 x 62.4	237.5	2,558	3.6	11'10"
Pengrowth Corporation Room 305	48	72	126	54	72	90	39	175	12.5 x 12.5	41 x 41	156.25	1,681	3.6	11'10"
Room 302	16	24	32	12	16	20	21		7.8 x 4.8	25.7 x 15.9	37.44	408	3.6	11'10"
Xerox Canada Ltd. Room 304	12	18	32	12	16	20	21		7.2 x 4.8	23.8 x 15.9	34.56	378	3.6	11'10"
Room 306	16	24	36	18	24	30	24		8.8 x 5.1	28.11 x 16.9	44.88	475	3.6	11'10"
Room 308	12	18	32	12	16	20	21		7.2 x 4.8	23.8 x 15.9	34.56	378	3.6	11'10"
Room 310	12	18	32	12	16	20	21		7.8 x 4.8	25.7 x 15.9	37.44	408	3.6	11'10"

Please Note: All capacity numbers are based on basic AV set-ups.
 All room set-ups based on using banquet chairs, except where indicated.

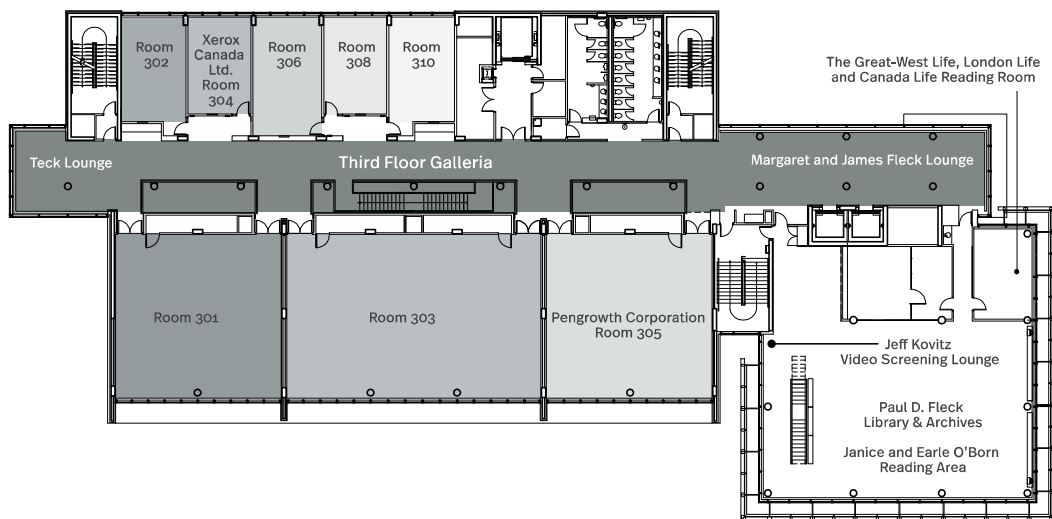



“We held our conference in the Kinnear Centre for the first time this year. The service from start to finish was excellent. Quality of food, staff and facilities were outstanding. We intend to come back again.”

Glyn J. Smith, Administrator
Pain Society of Alberta